



PARKVILLE 208

Upgrade Facade

Platform Estate, Kalkallo

3  2  2 

Priced From \$548,936

Lot Address: **Lot 411 Stringybark Drive**

Lot Size: **336m²**

Lot Dimensions: **12.5m x 28m**

House & Land Package Includes:

- Site Cost Allowance
- OHS, Council & Developer Requirements
- Flooring Throughout
- Coloured Driveway
- 2550mm Ceiling Height (ground floor only)
- 900mm Stainless Steel appliances incl Dishwasher
- 20mm Essastone to Kitchen Benches
- Evaporative Cooling
- Plus much much more

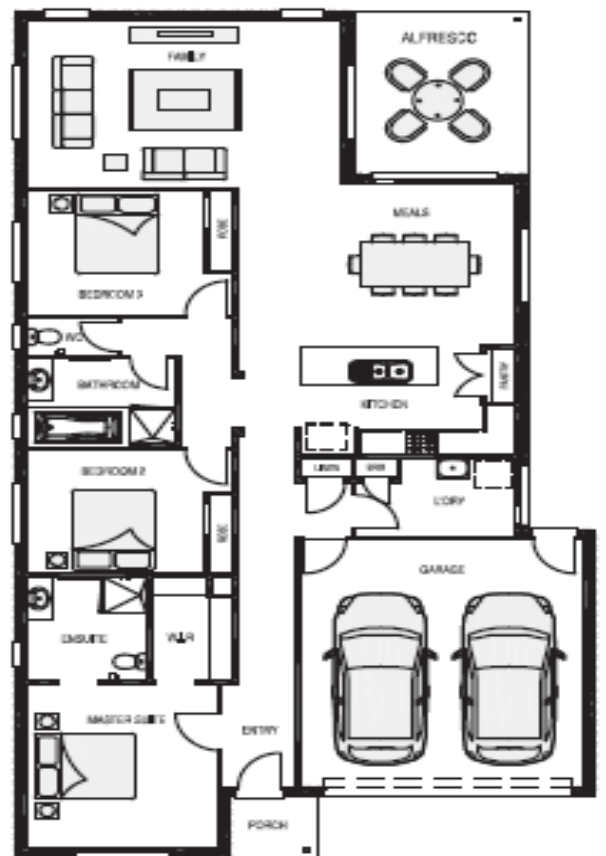

The information contained in this brochure is to be used as a guide only. Prices are subject to change according to soil & test survey. Images are for illustrative purposes only. Promotions may change at any time.

Please call John Wilson on 0451 039 321 or email johnw@zuccalahomes.com.au

HOUSE & LAND PKG — PARKVILLE 208

Priced From **\$548,936***

**Based on standard floorplan, facade and standard inclusions*

PARKVILLE 208

The Parkville 208 is a smart, sophisticated and economical home.

Featuring an open plan kitchen/meals connected to a large living area all opening onto an alfresco. Comprising three bedrooms and a generous master suite including walk in robe and ensuite; when it comes to entertaining, relaxing and anything in between, the Parkville 208 has you covered.

A perfect design for singles, downsizers, and first home buyers alike.

HOUSE EXTERNAL DIMENSIONS

House Width:	11280mm
House Length:	20620mm

AREA	m2	SQUARES
Living	155.63 m2	16.75 sq
Garage	36.25 m2	3.90 sq
Porch	2.52 m2	0.27 sq
Alfresco	13.38 m2	1.44 sq
Total Area	207.78 m2	22.36 sq

ROOM DIMENSIONS

Family	6.10m x 4.06m	Meals	4.73m x 3.92m	Master	3.70m x 4.00m
Bed 2	3.41m x 3.00m	Bed 3	3.41m x 3.00m	Alfresco	3.14m x 3.72m
Garage	5.51m x 6.02m				